

Limit Switches

Type L

Selection Information - Lever Arm

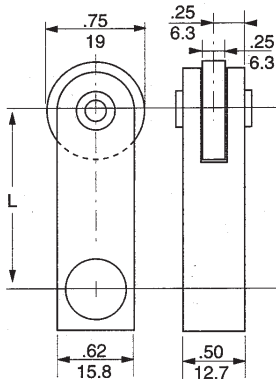

Style A

- Over 400 styles of levers to accommodate most of the industrial applications
- Made of **aluminum** bar stock hardened to 68,000 psi tensile strength to combine strength with light weight
- **Positive trip action** implemented by 48 broached serrations on lever and shaft ensures no loss of mechanical contact (slippage) even if the lever is loosely mounted on the shaft.
- **Lever position can be adjusted in 7 1/2° increments.**

Style A - Steel roller (.25" wide, .75" diameter)

Length (L) Inches (mm)	Lever number	Price
1.25 (31.7)	AC	\$7.00
1.50 (38.1)	AA	7.00
1.75 (44.4)	AD	9.00
2.00 (50.8)	AH	9.00
2.25 (57.1)	AJ	9.00
2.50 (63.5)	AO	9.00
2.75 (69.8)	AK	9.00
3.00 (76.2)	AB	9.00
3.50 (88.9)	AL	13.00
4.00 (101.6)	AM	13.00
4.50 (114.3)	AN	13.00
5.00 (127.0)	AP	15.00
5.50 (139.7)	AQ	15.00
6.00 (152.4)	AR	15.00

Options

Description	Suffix	Price adder
1" diameter roller	1	\$1.00
1 1/4" diameter roller	4	3.00
1 1/2" diameter roller	2	3.00
Nylon roller	N	NC
Ball bearing roller (3/4" diameter)	R	18.00
Stainless steel roller pin nylon roller	NS	1.00

Ex: AB1; ABR

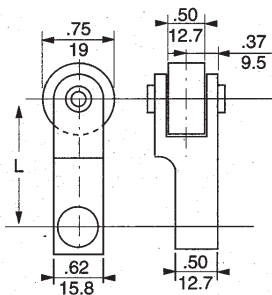

Style B

Style B - Steel roller (.5" wide, .75" diameter)

Length (L) Inches (mm)	Lever number	Price
1.50 (38.1)	BA	\$13.00
2.00 (50.8)	BH	15.00
2.50 (63.5)	BO	15.00
3.00 (76.2)	BB	15.00
4.00 (101.6)	BM	19.00
4.50 (114.3)	BN	19.00
5.50 (139.7)	BQ	21.00
6.00 (152.4)	BR	21.00

Options

Description	Suffix	Price adder
Nylon roller	N	NC
1 1/2" diameter	2	\$6.00

EX: BAN; BA2

Note: Other options available. Contact your Square D/Telemecanique representative for more details.

