

C60H-DC (Curve C)



PB107193-34.eps



PB107194-34.eps



IEC/EN 60947-2

The C60H-DC circuit breakers are used in direct current circuits (Not suitable for PV installations in Australia or New Zealand as they are polarised, refer to AS/NZS 5033)
They combine the following functions of circuit protection against short circuit and overload currents, control and isolation.



Direct current (DC)						
Breaking capacity (Icu) according to IEC/EN 60947-2						Rated service breaking capacity (Ics)
Type	110 V	220 V	250 V	440 V	500 V	
1P	110 V	220 V	250 V	440 V	500 V	75 % Icu
Rating (In) 1 to 63 A	20 kA	10 kA	6 kA	-	-	
2P (in series)	110 V	220 V	250 V	440 V	500 V	75 % Icu
1 to 63 A	-	20 kA	20 kA	10 kA	6 kA	

Catalogue numbers

C60H-DC		
Type	1P	2P
	<p>DB116588</p>	<p>DB124110 DB124111</p>
	Supply from above or below, observing the polarity	Supply from above Supply from below
Auxiliaries	Remote signalisation and tripping, module CA907008	
Rating (In)	Curve C	Curve C
1 A	A9N61501	A9N61521
2 A	A9N61502	A9N61522
3 A	A9N61503	A9N61523
4 A	A9N61504	A9N61524
5 A	A9N61505	A9N61525
6 A	A9N61506	A9N61526
10 A	A9N61508	A9N61528
13 A	A9N61509	A9N61529
15 A	A9N61510	A9N61530
16 A	A9N61511	A9N61531
20 A	A9N61512	A9N61532
25 A	A9N61513	A9N61533
30 A	A9N61514	A9N61534
32 A	A9N61515	A9N61535
40 A	A9N61517	A9N61537
50 A	A9N61518	A9N61538
63 A	A9N61519	A9N61539
Number of modules of 9 mm	2	4
Accessories	Modules CM907007 and CA907012	

C60H-DC (Curve C) (cont.)

Connection

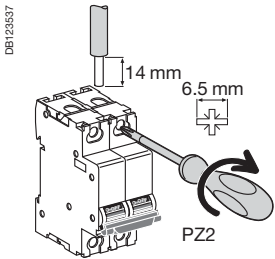

Rating	Tightening torque	Without accessory		With accessories			
		Copper cables		50 mm ² Al terminal	Screw-on connection for ring terminal	Multi-cables terminal	
		Rigid / Stranded	Flexible or ferrule			Rigid cables	Flexible cables
≤ 25 A	2.5 N.m						
> 25 A	3.5 N.m /	1 to 25 mm ²	1 to 16 mm ²	50 mm ²	Ø 5 mm	3 x 16 mm ²	3 x 10 mm ²
		1 to 35 mm ²	1 to 25 mm ²	-			

Multi-cables connection

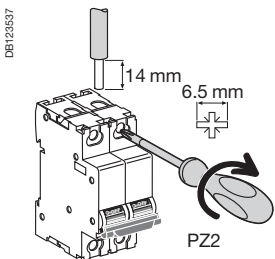

Rating	Tightening torque	Without accessory			
		2 Copper cables		3 Multi-cables / Different wires	
		Rigid / Stranded	Flexible or ferrule	Flexible / Stranded	Flexible / Stranded / Rigid
≤ 25 A	2.5 N.m				
> 25 A	3.5 N.m	2 x 1 mm ² to 2 x 10 mm ²		3 x 1 mm ²	2 x 2.5 mm ² + 1 x 1.5 mm ²
		2 x 1 mm ² to 2 x 16 mm ²		3 x 4 mm ²	2 x 10 mm ² + 1 x 6 mm ²

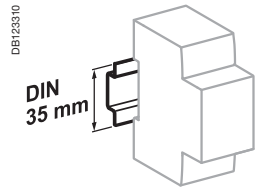

Clip on DIN rail 35 mm.

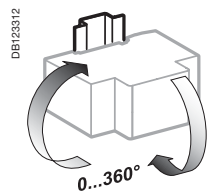

Indifferent position of installation.

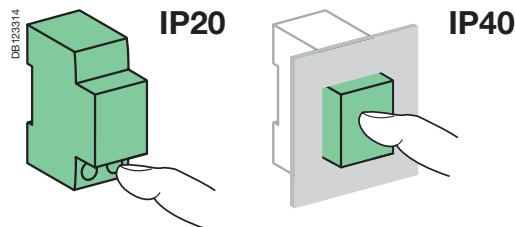

Technical data

- Tripping curves: C curve - overcurrent protection for any type of application.
- Positive break indication - the green strip provides positive indication of the state of the contacts.
- Suitable for isolation as defined in IEC / EN 60947-2.
- Increase in the service life of the product: thanks to fast closure independent of the speed of action on the handle.
- Current limitation in the event of a fault: fast opening of the contacts prevents the loads from being destroyed in the event of a short circuit.

Main characteristics		
According to IEC/EN 60947-2		
Insulation voltage (Ui)		500 V DC
Rated voltage (Un)	1P	250 V DC
	2P	500 V DC
Operating voltage (Ue)	1P	24...250 V DC
	2P	24...500 V DC
Pollution degree		3
Rated impulse withstand voltage (Uimp) under frame		6 kV
Magnetic tripping (Ii)		8.5 In (± 20 %) (compatible with curve C)
Additional characteristics		
Degree of protection (IEC 60529)	Device only	IP20
	Device in modular enclosure	IP40
Utilisation category		A (no delay in accordance with IEC/EN 60947-2 standards)
Endurance (O-C)	Electrical	3,000 cycles (where L/R=2 ms)
		6,000 cycles where the circuit is resistive
	Mechanical	20,000 cycles
Tropicalisation (IEC 60068-2)		Treatment 2 (relative humidity 95 % at 55°C)
Operating temperature		-25°C to 70°C
Storage temperature		-40°C to 85°C



Failure to match polarity during connection may lead to a fire hazard and/or serious injury.

- The connection polarity must be observed (marked on the front panel).
- Use only with direct current.
- Not suitable for PV installations in Australia or New Zealand.

C60H-DC (Curve C) (cont.)

Weight (g)

Circuit breaker	
Type	C60H-DC
1P	128 g
2P	256 g

Dimensions (mm)

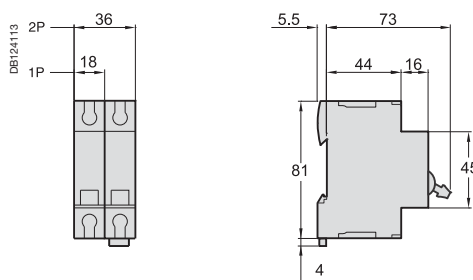

C60H-DC

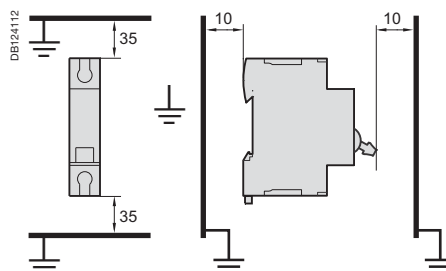

Details of minimum distance between circuit breaker and earthed metal parts for circuit breaker intended for use without enclosure.